

WFT OFFSHORE LW 2-Speed

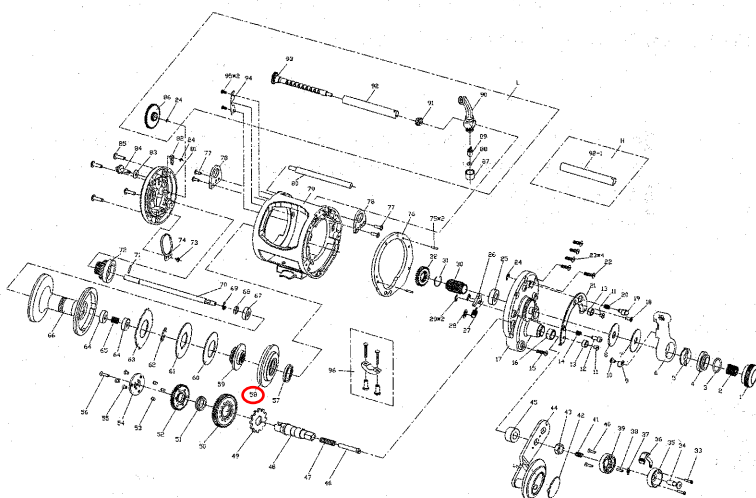

NO	Part Name	NO	Part Name	NO	Part Name
1	Pre-Set Knob	34	Shift Bottom (Low Speed)	67	Ball Bearing
2	Spring	35	Shift Housing	68	Bushing
3	O-Ring	36	Shift Bottom (High Speed)	69	E-Clip
4	Brake Cam	37	Spring	70	Spool Shaft
5	Lifter	38	Pin	71	Pin For Spool Shaft
6	Brake Lever	39	Handle Nut Retainer	72	Line Out Alarm Cog. Wheel
7	Washer	40	Screw (x2)	73	Screw
8	Washer	41	Shift Spring (Heavy)	74	Click Power Spring
9	Click Plate	42	Handle Knob Cap	75	Pin (x2)
10	Screw	43	Handle Nut	76	Plate
11	Screw (x2)	44	Handle Assembly	77	Screw (x4)
12	Locating Button	45	Bushing	78	Frame
13	Washer (x2)	46	Shift Plunger	79	Frame
14	Spring	47	Shift Spring (Light)	80	Line Carriage Support Shaft
15	Screw	48	Main Gear Shaft	81	Left Side Plate
16	Bushing	49	Ratchet Gear	82	Click Pawl
17	Right Side Plate	50	Main Gear (High Speed)	83	Plastic Washer
18	Screw	51	Lock Nut	84	Click Button
19	Locating Button	52	Main Gear (Low Speed)	85	Screw (x4)
20	Spring	53	Coupling Pin (x3)	86	Osc. Cog Wheel
21	Fix Plate	54	Coupling Plate	87	Pilot Guide Cap
22	Screw	55	Coupling Screw (x3)	88	Washer
23	Screw x4	56	Plunger Screw	89	Pilot Guide
24	E-Clip (x2)	57	Waterproof Washer	90	Line Carriage Assembly
25	Ball Bearing	58	Waterproof Cover	91	Bushing
26	Anti-Reverse Pawl	59	Brake Washer Retainer	92	Level Wind Guard
27	Anti-Reverse Spring	60	Spring Washer	92-1	Tube
28	Quick Washer	61	Brake Washer	93	Worm Shaft Assembly
29	E-Clip (x2)	62	C-Clip	94	Level Wind Lock Plate
30	Pinion Gear	63	Teflon Brake Washer	95	Rivet (x2)
31	C-Clip	64	Ball Bearing (x2)	96	Rod Clamp Hardware
32	Pinion Gear (Low Speed)	65	Spring		
33	Screw (x2)	66	Spool		

WFT OFFSHORE LW^{LH} 2-Speed

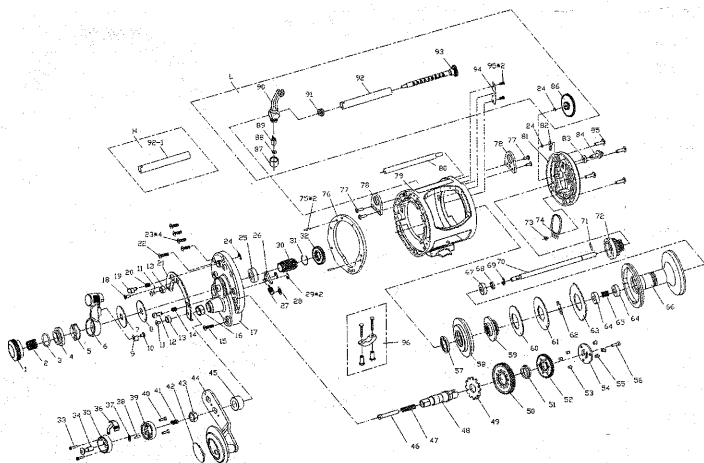

NO	Part Name	NO	Part Name	NO	Part Name
1	Pre-Set Knob	34	Shift Bottom (Low Speed)	67	Ball Bearing
2	Spring	35	Shift Housing	68	Bushing
3	O-Ring	36	Shift Bottom (High Speed)	69	E-Clip
4	Brake Cam	37	Spring	70	Spool Shaft
5	Lifter	38	Pin	71	Pin For Spool Shaft
6	Brake Lever	39	Handle Nut Retainer	72	Line Out Alarm Cog. Wheel
7	Washer	40	Screw (x2)	73	Screw
8	Washer	41	Shift Spring (Heavy)	74	Click Power Spring
9	Click Plate	42	Handle Knob Cap	75	Pin (x2)
10	Screw	43	Handle Nut	76	Plate
11	Screw (x2)	44	Handle Assembly	77	Screw (x4)
12	Locating Button	45	Bushing	78	Frame
13	Washer (x2)	46	Shift Plunger	79	Frame
14	Spring	47	Shift Spring (Light)	80	Line Carriage Support Shaft
15	Screw	48	Main Gear Shaft	81	Left Side Plate
16	Bushing	49	Ratchet Gear	82	Click Pawl
17	Right Side Plate	50	Main Gear (High Speed)	83	Plastic Washer
18	Screw	51	Lock Nut	84	Click Button
19	Locating Button	52	Main Gear (Low Speed)	85	Screw (x4)
20	Spring	53	Coupling Pin (x3)	86	Osc. Cog Wheel
21	Fix Plate	54	Coupling Plate	87	Pilot Guide Cap
22	Screw	55	Coupling Screw (x3)	88	Washer
23	Screw x4	56	Plunger Screw	89	Pilot Guide
24	E-Clip (x2)	57	Waterproof Washer	90	Line Carriage Assembly
25	Ball Bearing	58	Waterproof Cover	91	Bushing
26	Anti-Reverse Pawl	59	Brake Washer Retainer	92	Level Wind Guard
27	Anti-Reverse Spring	60	Spring Washer	92-1	Tube
28	Quick Washer	61	Brake Washer	93	Worm Shaft Assembly
29	E-Clip (x2)	62	C-Clip	94	Level Wind Lock Plate
30	Pinion Gear	63	Teflon Brake Washer	95	Rivet (x2)
31	C-Clip	64	Ball Bearing (x2)	96	Rod Clamp Hardware
32	Pinion Gear (Low Speed)	65	Spring		
33	Screw (x2)	66	Spool		

Vertrieb und Service:

World Fishing Tackle GmbH & Co.KG

Kaldenhausener Str. 41, 47802 Krefeld, Fax. 02841-88 76 75, Email: info@world-fishing-tackle.de

www.world-fishing-tackle.de

Leadership  for Success

Service-Hotline: 02841-1235813

Der Verbindungspreis beträgt 0,95 Euro pro Minute aus dem deutschen Festnetz.